

## Introduction

The Tess 120 system is an internally mounted guided tension blind.

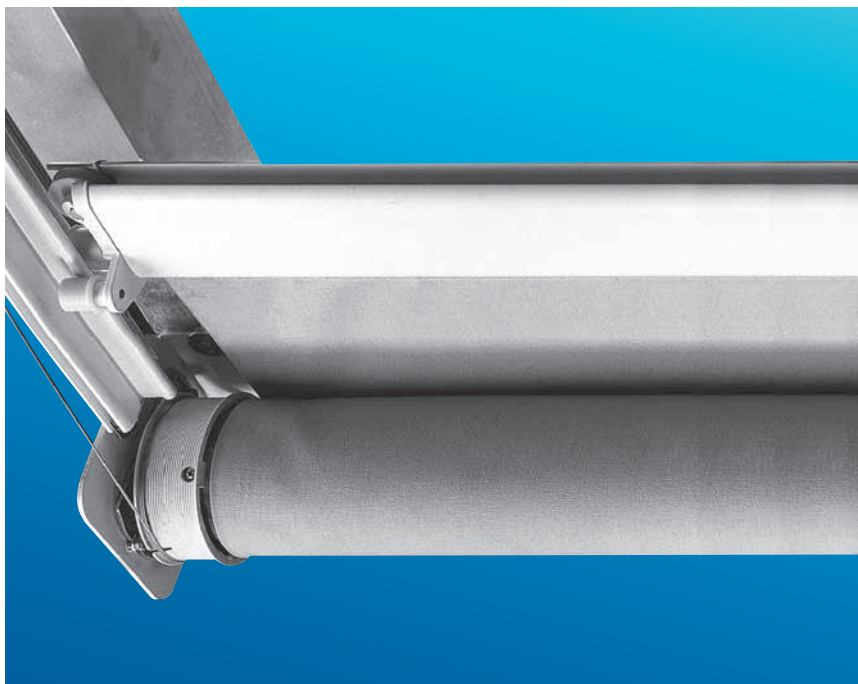

## Technical specification

Model	T11012	
Maximum width	(m)	5
Maximum draw	(m)	6
Maximum fabric area	(m <sup>2</sup> )	18
Basic weight	(kg)	7.5
+ per metre width	(kg)	4.2
+ per metre draw	(kg)	3
Motor torque	(Nm)	15
Motor speed	(min <sup>-1</sup> )	17
Motor current at 230V	(A)	0.6
Motor cable length	(m)	2.5
Temperature range	(C°)	-5 to +55
Maximum run time	(min)	4
Minimum fabric speed	(m/min)	5

## Materials

Hem-bar, side guide, all mounting brackets and relieving roller - polyester powder coated aluminium.

Fabric roller - galvanised steel.

Draw cable - nylon coated stainless steel.

Cable spools - Glass reinforced nylon.

# Details

Fabric Roller

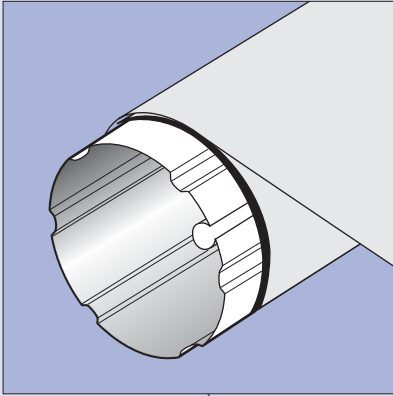

Top fix mounting bracket

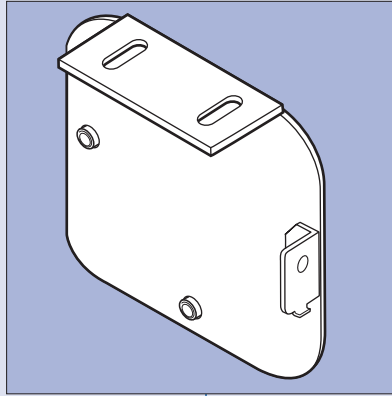

Side guide bracket

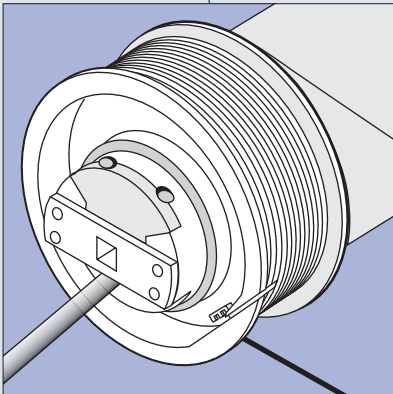
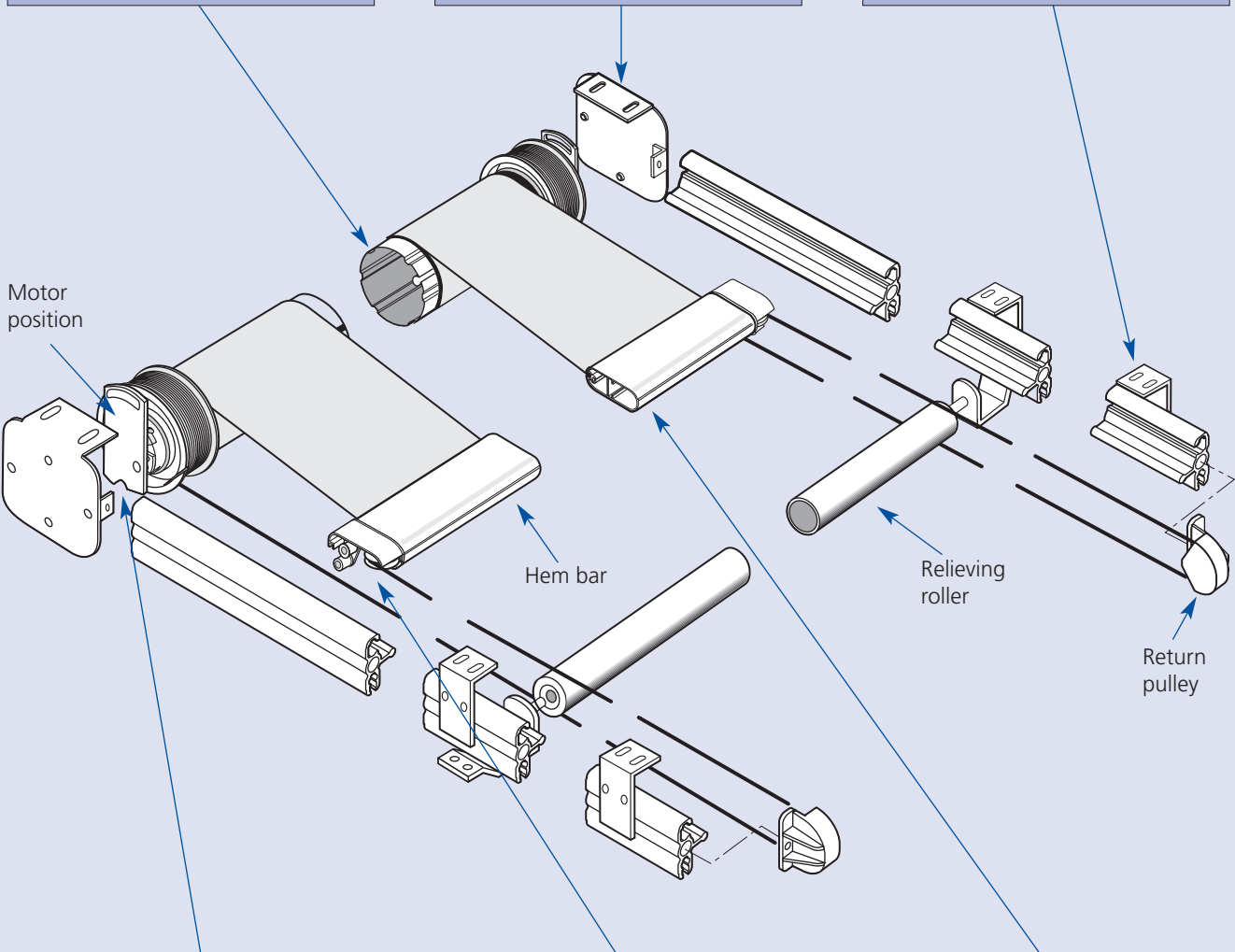
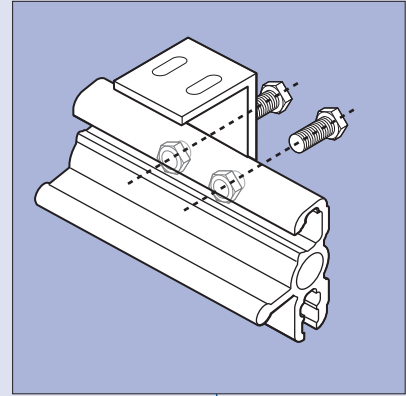

Motor with cable spool  
(without mounting plate)

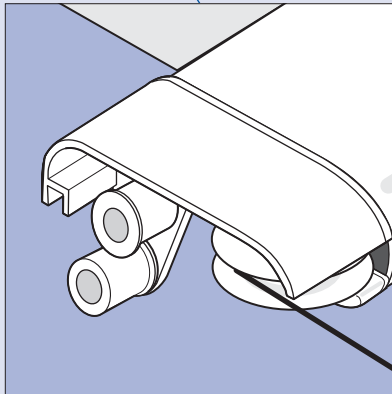

Hem bar end cap

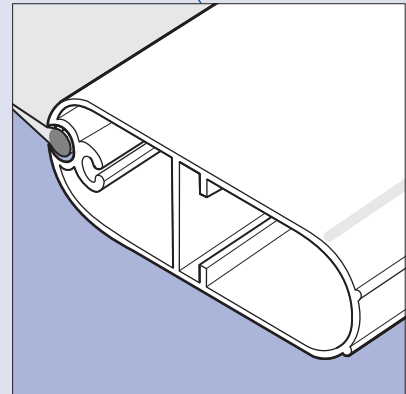

Hem bar

## Installation examples

For full installation details see drawings GDP10998/01 and GDP10999/02

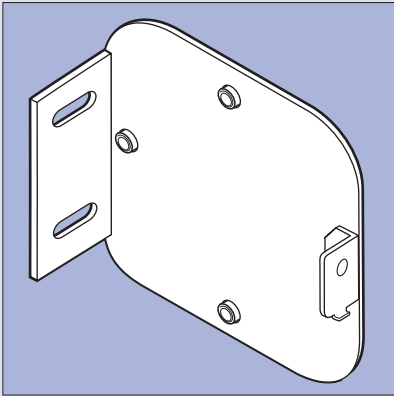

Back fix mounting bracket

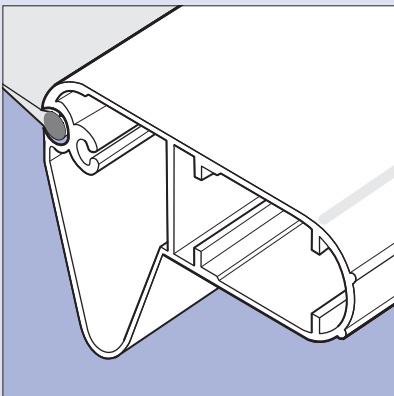

Heavy duty hem bar

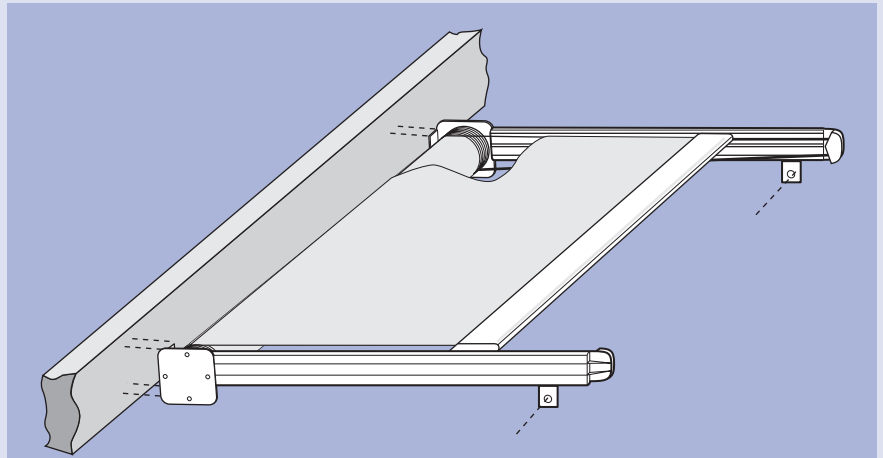

Back fix installation with additional side fix brackets

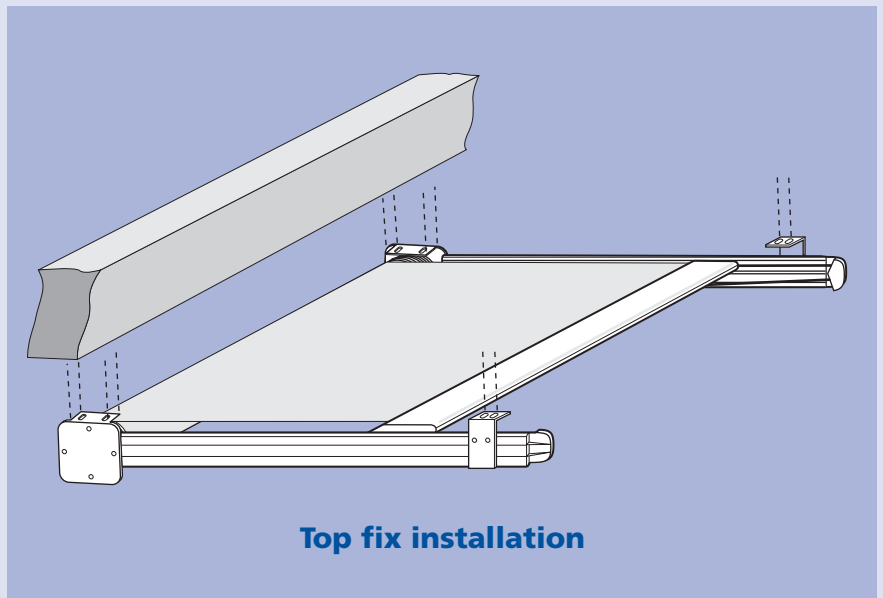

Top fix installation

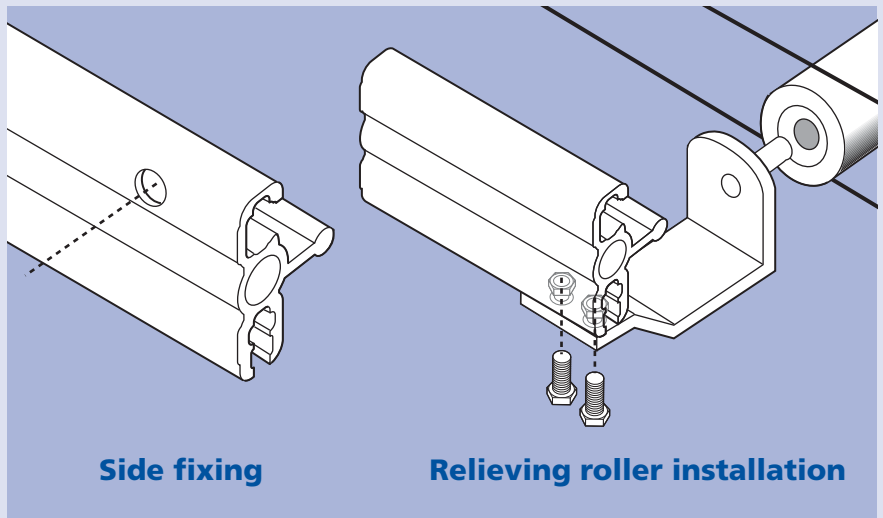

Side fixing

Relieving roller installation

Dimensions

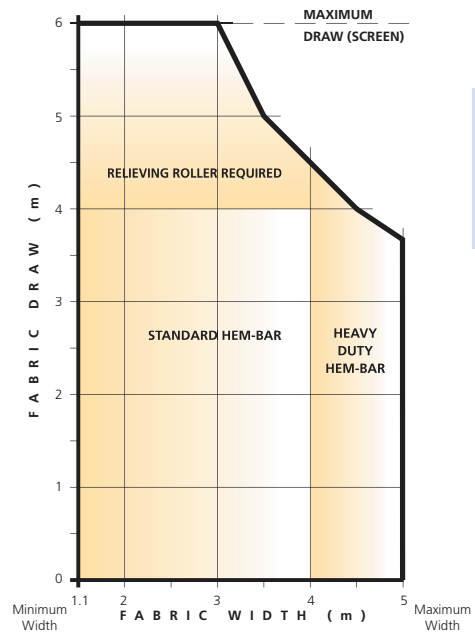
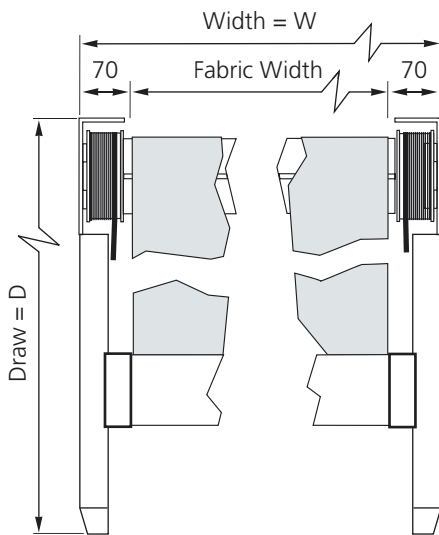
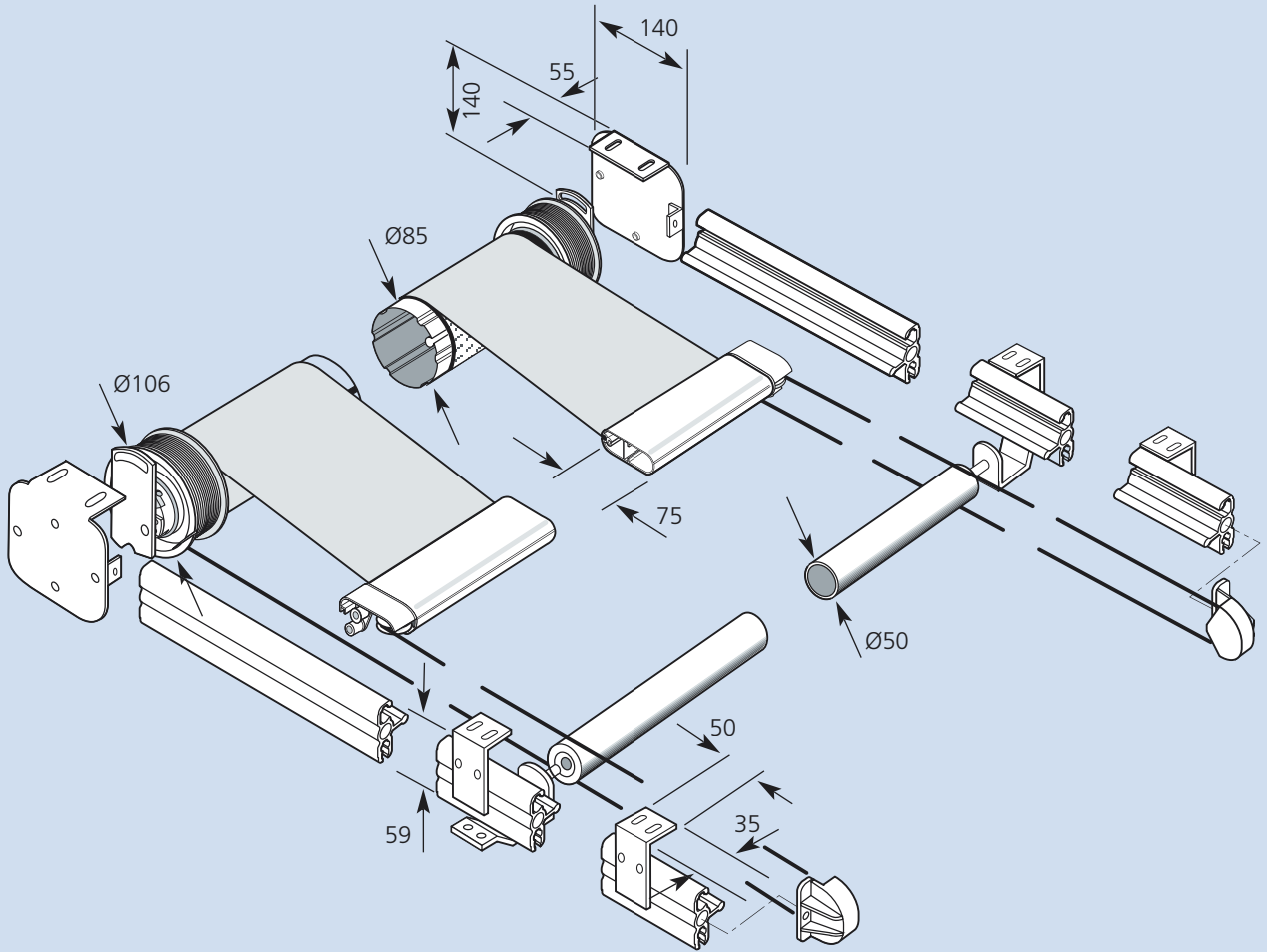

Maximum fabric area 18m<sup>2</sup>  
Maximum fabric weight 450 g/m<sup>2</sup>

**Guthrie Douglas**

**LUXBEST**

Vilholtevej 47  
DK-8740 Brædstrup  
Tlf +45 7575 3080 Fax +45 7575 3082  
mail@luxbest.dk www.luxbest.dk



Assessed to ISO 9001: 2000  
Certificate No 193